



Sonoma Glen
AT WEST PARK

SILVERADO

2104 square feet

3/2.5/2

Priced from \$441,900



STANDARD FEATURES

- 3 Bedrooms
- 2.5 Baths
- 2 Car Garage
- 5 Star Energy Rating
- Stainless Steel Appliances
- 9' Ceilings on main level
- Extensive closets with space saving organizers
- Direct Vent Gas Fireplace
- Large rear deck backs up to planned green space with the option of enclosing a private backyard area



GORDON SLOANE
Realtor
907.244.3381



\$3,000

UP TO
IN CLOSING COST ASSISTANCE.
See listing licensee for details and restrictions.

Prices noted are base prices only. All square footages are approximate. Floorplans, elevations and photos or renderings may vary. Items on floorplans, elevations or photos may be options, upgrades or allowance overages and may not be included in price. Builder reserves the right to change prices at any time without notice. Please see Gordon Sloane for details of upgrades or options in homes under construction and for sale.

Revised 4/19/18



Sonoma Glen
AT WEST PARK

SILVERADO

Floor Plan Layouts



1ST FLOOR



2ND FLOOR

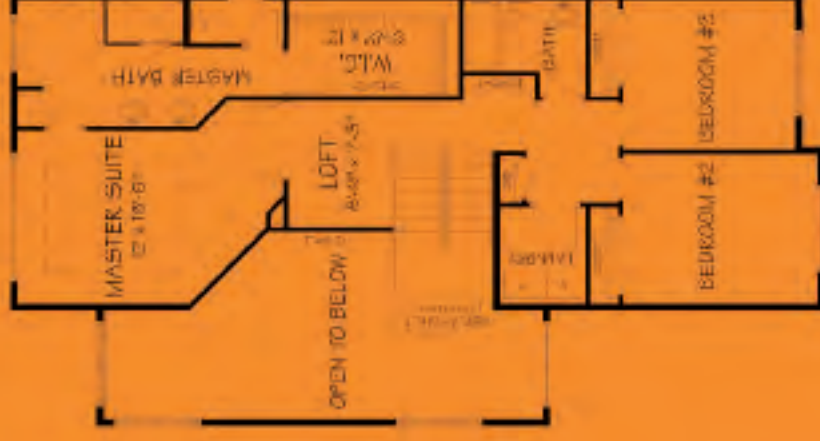

- Covered Entry
- Bright 2 story foyer and great room with a large entry closet
- Gourmet kitchen with center island and large walk-in pantry
- Guest bath on main level
- Spacious master suite with coffered ceiling, double vanity, private commode, walk-in closet, garden tub and separate walk in shower
- Upstairs laundry room
- Loft area upper level

2104 square feet

FROM \$441,900



www.ThePetersenGroup.com